

FUMEX® ASE/ASEM

Manual and motor-driven exhaust hose reels for worksites with stationary vehicles



The ASE (M) hose reel provides a handy solution for working with stationary vehicles, where you want to make the work area uncluttered or when the extractor is not being used.

The ASE has a spring return. For high ceilings and cases involving long hoses, the ASEM, a motor-driven hose reel, is available.

The product's lightweight construction of aluminum/steel plate makes it easy for it to be fitted to ceilings, walls or floors.

Hose reels are available in three different widths and are equipped as standard with an EPDM hose which can be reshaped, with dimensions of 75, 100, 125 or 150 mm.

The hose reel system is connected to a separate fan or a central exhaust system.

The Fumex range also includes fans, accessories and automatic control gear suitable for exhaust extraction.

EXHAUST EXTRACTION
Pure advantages

Dimension drawing (mm)

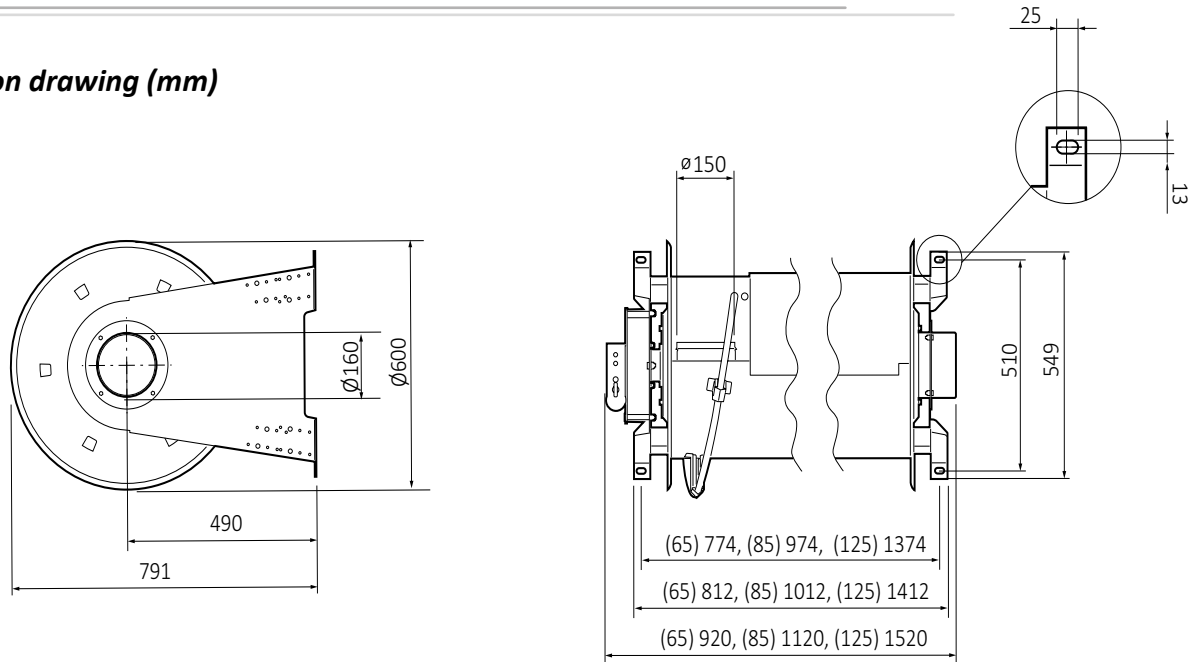

Designation		Ø (mm)	Hose length (m)	Drop (m)
Manual return	Motorized return			
Dimension Ø75 mm				
ASE 65-75/5	ASEM 65-75/5	75	5	-
ASE 65-75/7.5	ASEM 65-75/7.5	75	7.5	-
ASE 65-75/10	ASEM 65-75/10	75	10	-
Dimension Ø100 mm				
ASE 65-100/5	ASEM 65-100/5	100	5	-
ASE 65-100/7.5	ASEM 65-100/7.5	100	7.5	-
ASE 65-100/10	ASEM 65-100/10	100	10	2
ASE 85-100/10	ASEM 85-100/10	100	10	-
Dimension Ø125 mm				
ASE 65-125/5	ASEM 65-125/5	125	5	-
ASE 65-125/7.5	ASEM 65-125/7.5	125	7.5	-
ASE 65-125/10	ASEM 65-125/10	125	10	2.7
ASE 85-125/10	ASEM 85-125/10	125	10	-
ASE 85-125/12.5	ASEM 85-125/12.5	125	12.5	2.5
ASE 125-125/15	ASEM 125-125/15	125	15	-
Dimension Ø150 mm				
ASE 65-150/5	ASEM 65-150/5	150	5	-
ASE 85-150/7.5	ASEM 85-150/7.5	150	7.5	-
ASE 85-150/10	ASEM 85-150/10	150	10	2
ASE 125-150/10	ASEM 125-150/10	150	10	-
ASE 125-150/12.5*	ASEM 125-150/12.5	150	12.5	-
ASE 125-150/15*	ASEM 125-150/15	150	15	1.5

*Extra spring assembly included.

This function is applicable when using a Fumex original AG hose and Fumex nozzle with a weight of max 2.8 kg.

Recommendation:

The recommended installation height for ASE is 3-4 m; an extra spring assembly is required if installed any higher. Motor operation is always recommended when installing the reel at heights above 3-4 m in combination with hose lengths over 10 m.



Accessories

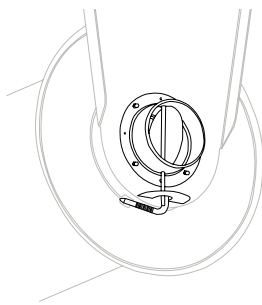

ASES-160 Automatic damper

An automatic mechanical butterfly damper is fitted in the connection sleeve. The damper is activated by the hose reel's rotation - when the hose is extended the damper opens. When the hose is reeled in, the damper is closed.

The damper has a clear indicator, showing whether the damper is open or closed. The ASES-160 is an energy-saving accessory which can be supplemented with fan pressure control to make the system more efficient.

Fits: ASE/ASEM

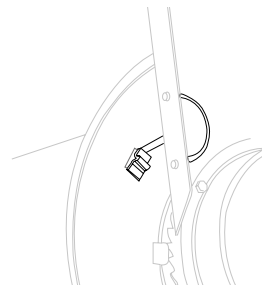

ASE 865 Switch for fan/electric damper control

An externally fitted switch is activated by the hose reel's rotation.

Switch is used to automatically start/stop the fan and electric damper.

A Fumex S 600/S 400 control unit is used as the finishing touch to the system. See the separate product sheet on automatic control units for vehicle exhausts.

Max 24 V supply voltage.

Fits: ASE/ASEM

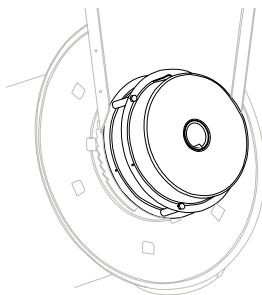

ASEMS Extra spring assembly for manual hose reels

An additional spring assembly is equipped when additional lifting power is required, e.g. for long hoses, thick hoses/nozzles, and when hoses are fitted at a high height. Supplied complete with drive shaft.

Weight: 7,5 kg

Fits: ASE



ASL-160

Hose, 0.2 m with hose clips for connecting the hose reel and pipe.

Fits: ASE/ASEM

ASEM control devices

A control device is used to reel the hose out and in easily and conveniently, while helping prevent work-related injuries.



ASEM RADIO

Radio control set (transmitter/receiver).
IP 55

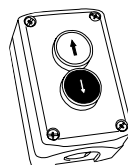

ASEM-1

Wall-mounted control device.
IP 66

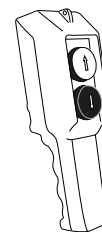

ASEM-2

Hanging control device.
IP 65

Additional information

Information about suitable nozzles for Fumex hose reels is available in a separate product sheet "Exhaust nozzles". Refer to the "Automatic control unit for exhausts" product sheet to find out the maximum energy savings and minimum noise level achievable.

Pressure drop (fully extended hose)

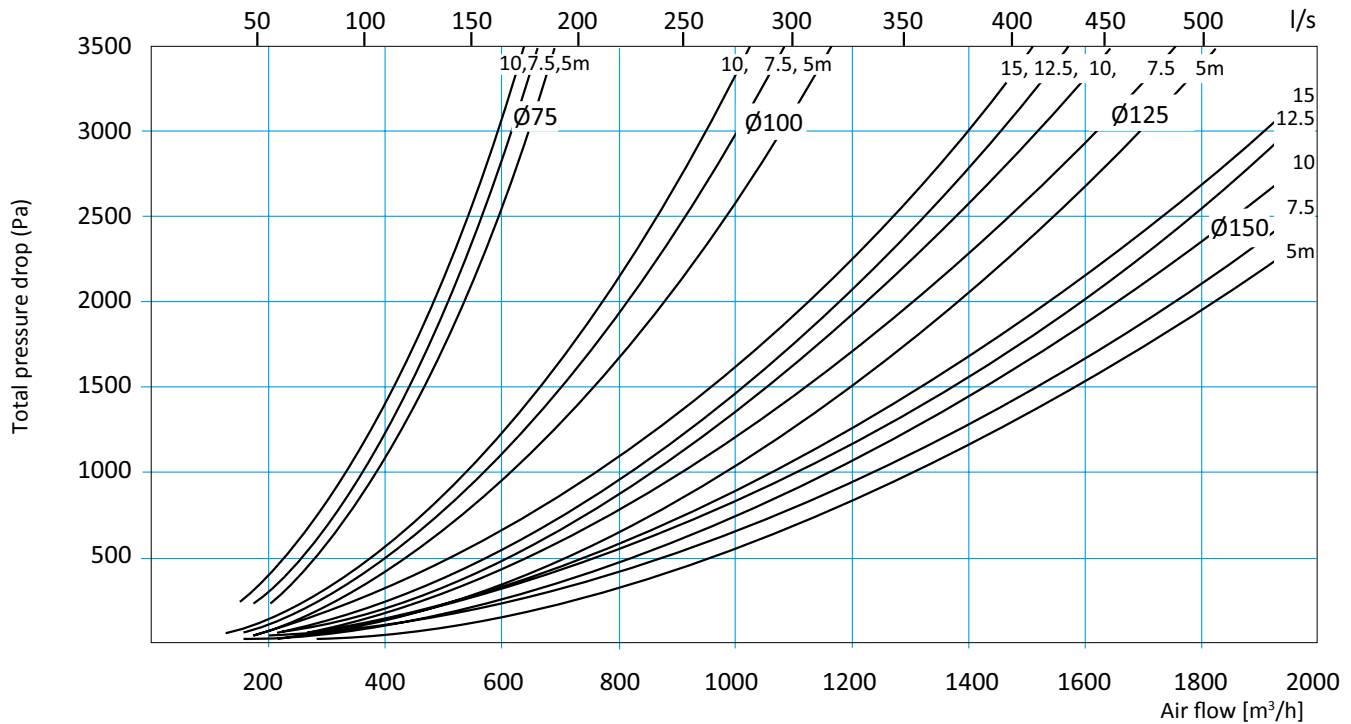

Recommended air flow rate for extraction in vehicle workshops

Activity	Air flow	
Private cars	400 m³/h	110 l/s
Trucks	1000 m³/h	280 l/s

This recommendation applies when the rpm and engine load are low.

Specifications

Form of delivery:

Supplied complete with AG hose type.

Surface treatment:

Sheet metal parts - Powder-coated.

Aluminum parts - Anodized.

AG hose type:

EPDM with polyester coil, can be reshaped, temperature range -30°C – 170°C.

Spring:

Clock spring, spring steel DIN 1234.

Motor (ASEM):

390 W, 230 V, 50 Hz, IP 33.

Weight:

ASE 65, 85, 125 - 35, 37, 40 kg.

ASEM 65, 85, 125 - 33, 35, 38 kg.