



www.ehcteknik.com

*The Original since 1983*

# Assembly Instruction EHC HT5

## **Head Office**

Sweden

### **EHC Teknik ab**

Ögärdesvägen 8a

S-433 30 Partille

Tel.: +46 (0)31 449020

Email. office@ehcteknik.se

www.ehcteknik.com

Benelux

### **EHC Teknik bvba**

Karel Soetelaan 37

B-2150 Borsbeek

Tel.: +32(0)3 3663936

Email. info@ehcteknik.be

www.ehcteknik.be

www.ehcteknik.nl

www.ehcteknik.fr

Deutschland

### **EHC Teknik GmbH**

Eiserfelder Str.316

D-57080 Siegen

Tel.: +49 (0)271 3177936

Email. buero@ehcteknik.de

www.ehcteknik.de

**Description EHC HT5 filter**

EHC HT filter for diesel engines

The HT filter is rust protected by zinc. Coating The unit can be mounted horizontal or vertically. And condensate is drained through the hose.

**4220655 - Maximum temperature, exhaust: 250°C**

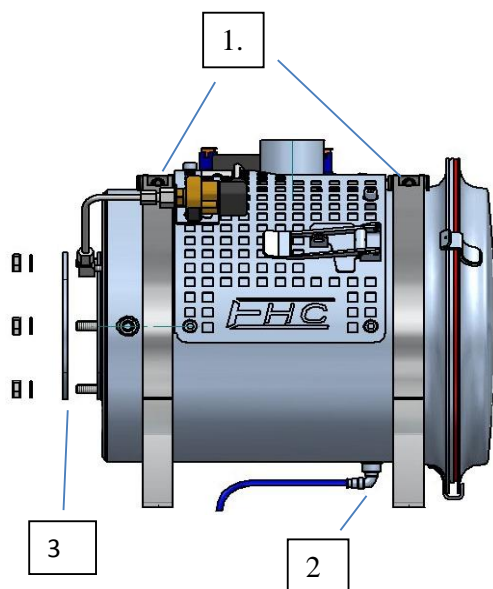
**Mounting:**

**Important!** Mount the unit with condensate hose (2) as the lowest point.

1. The unit is mounted using the two clamping rings (1), to the intended machine.
2. The lowest point, determines the hole for the outlet of the condensate (2)
3. Companion flange (3) appropriate to the size of the vehicle.

For the measurements of the filter unit and connections, see technical data



**Important!** Mount the device vibration-free

### Connection Instructions:

1. Determine the size of the exhaust tail pipe O/D.
2. Using one of the blank flanges provided, weld a connecting pipe to the center of the flange. The same size as your exhaust. Open up the centre of the flange to the same size as the pipe.
3. Using the bolts and gasket supplied, Fit the flange to the inlet of the filter.
4. Make up a tail pipe using the second flange ensuring that the outlet hole is no smaller than the I/D of the machine tailpipe.

**Warning:** Do not use the second flange to blank off the outlet if no tailpipe is required

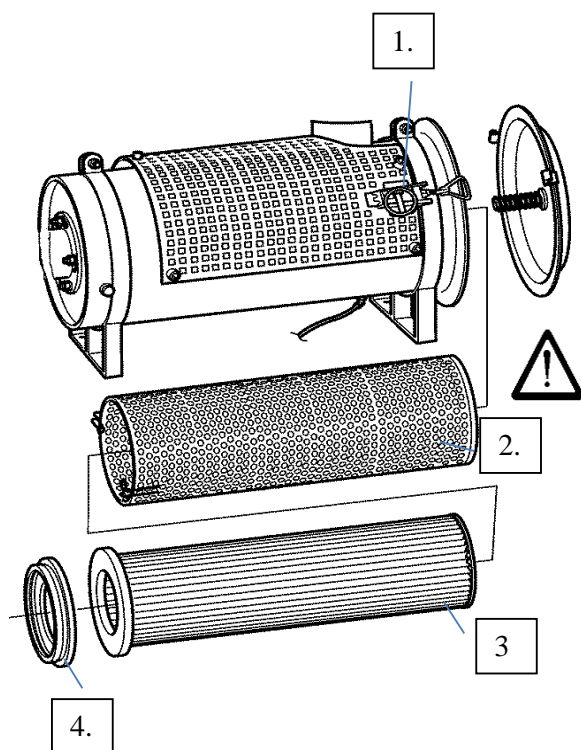

### Filter replacement

**Warning:!** Filter may be hot at filter change.

1. Loosen eccentric locks (1) on the filter housing.
2. Remove the filter container (2).
3. Remove the filter element (3) from the filter container (2) and insert the new filter cartridge.
4. Insert the filter canister with silicon gasket (4) first.

The used filter can be disposed of as combustible waste.

## Electrical pressure switch 12/24V

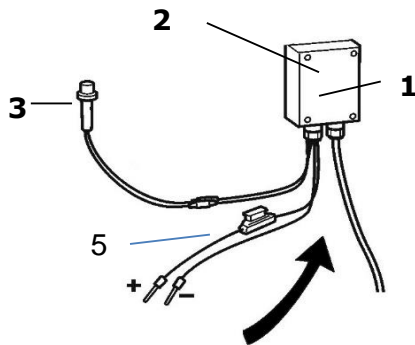

**Important!** Beware of not breaking the moisture blocking sealing on the guard at the assembly.



**Important!** Mount the delay relay protected in the cabin IP54)

The electrical pressure switch has a buzzer that sounds and a lamp that lights up when filter change is necessary. Pressure switch (4) is screwed into the existing socket on the unit as image.

Electrical connection + linked to the ignition switch, and - to the battery.

Mount the coupling device according to IP54<sup>1</sup>.

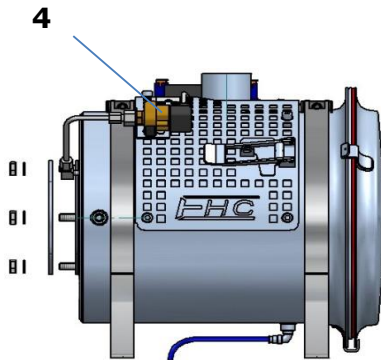

1. Delay relay, ~2min.
2. Buzzer
3. Lamp
4. Pressure switch
5. Fuse, 2A

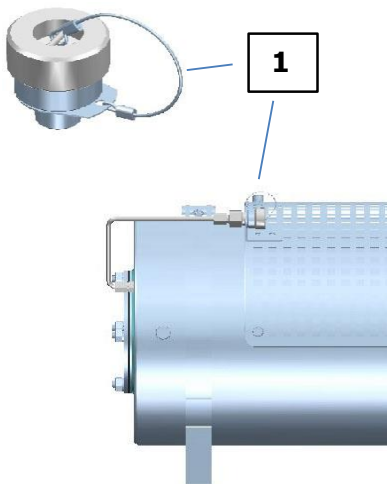

## Mechanical pressure guard (Optional)

The mechanical pressure guard (1) vents when filter replacement is necessary. Replace the membrane of the pressure guard when the filter cartridge replacement is made.

[1] IP54=Dust cover and withstand water spray from all angles

**Technical data:**

EHC HT Filter separates >99% (>0,12μ) of the particles in the exhaust.

**4220655 - Maximum temperature, exhaust: 250°C**

Max. K-Value recommended: 1.3

Weight: 14,5kg

Life expectancy depends on engine size, engine type, the engine used and engine condition.

EHC HT Filter meet the exhaust requirements:

- TRGS 554 (D)
- VERT Filter List: B416/06.15 (CH)
- COSHH (GB)

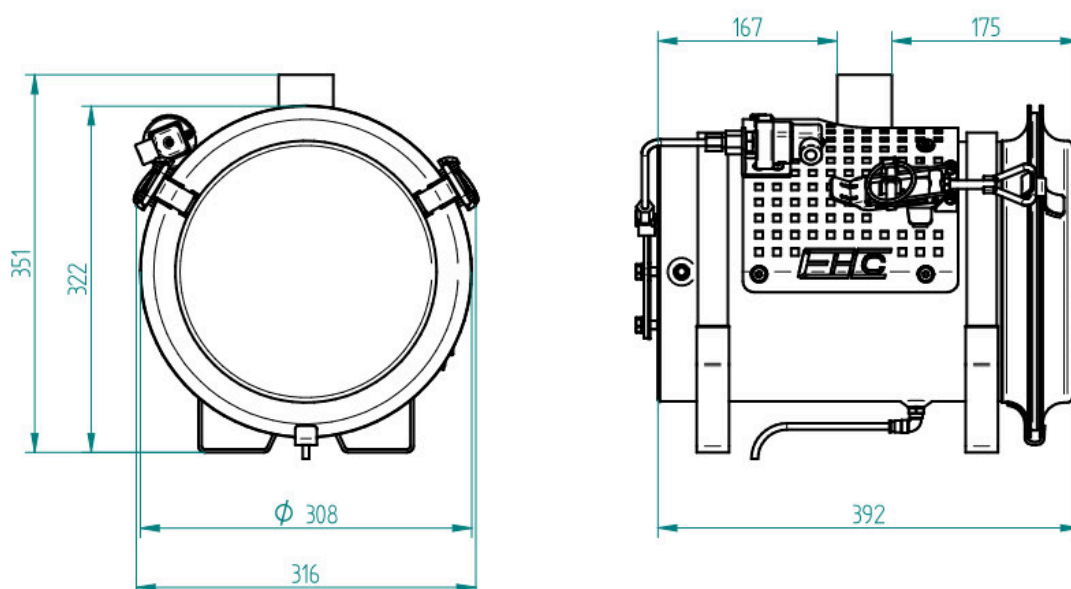
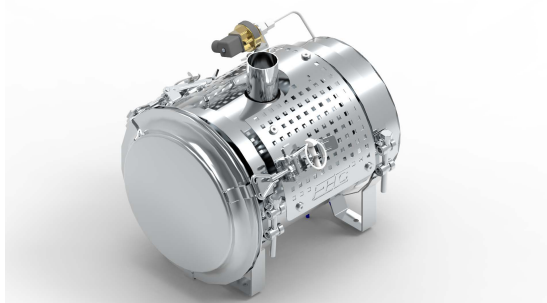

## Optional

### EHC Electric 3-way Valve

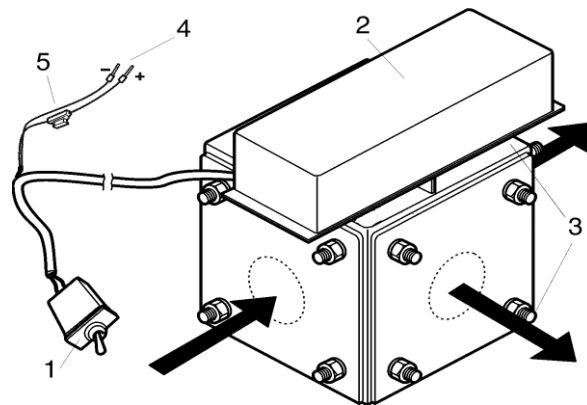

### Mounting

1. The valve is fitted between the engine, exhaust pipe and the HT filters as shown on picture. Make the necessary hole for the current tailpipe.
2. The control box is controlled by the toggle switch (1).  
The toggle switch is mounted in the cabin.
3. A lamp lights up red when the exhaust gas passes through the filter.  
Lamp mounted easily visible to the driver.
4. Connect the cable – to the battery –, (4).  
Connect the cable + to the ignition switch, clip 15, (4).
5. Fuse 2A

### EHC Manual 3-way Valve

